

CHESTNUT COURT
 7511 LEMONT RD STES 156-158
 DARIEN, IL 60561
 SQUARE FOOTAGE: 3,200
 UNIT 28

EXISTING CONSTRUCTION

FRONT: ALUM. STOREFRONT ASSEMBLY (1" INSUL. GLASS)
 SIDES: 1 HR. GYP. BD. DEMISING WALL
 REAR: GYP. BD. ON MTL. FRAMING OVER MASONRY

SALES/OFFICES/BREAK:
 OUTLETS & TELE/DATA (MISC. LOCATIONS)
 2x4 RECESSED FLUORESCENT & TRACK LIGHTING FIXTURES
 2x4 CEILING TILE & GRID
 FINISHES:
 PAINT & VINYL BASE

TOILET (PRE-2010 ADA):
 2x4 CEILING TILE & GRID
 2x4 RECESSED FLUORESCENT FIXTURE
 LAVATORY
 WATER CLOSET
 EXHAUST FAN
 FINISHES:
 PAINT & VINYL BASE

ELECTRICAL
 (2)100A 120/208V, 3Ø 4W 30 BRKR PANELS (1 EA. SUITE)
 WATER SERVICE 3/4" EACH SUITE

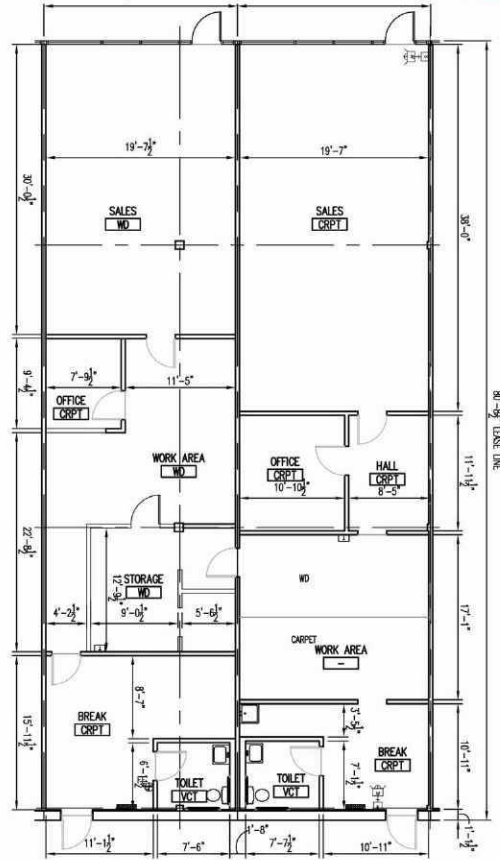

FLOOR PLAN
 SCALE: 3/32" = 1'-0"

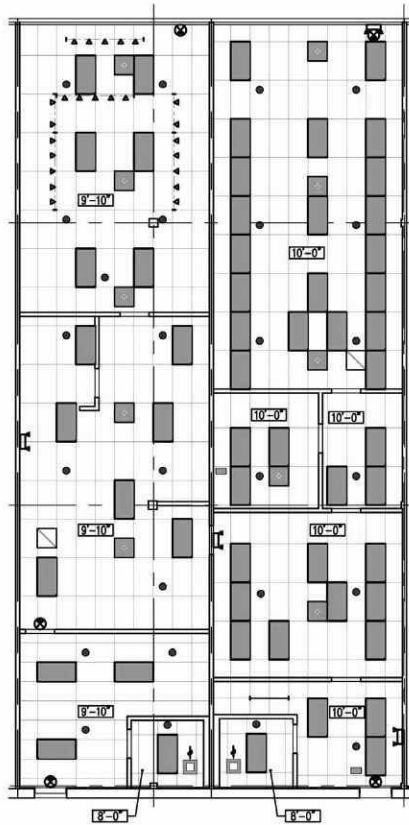

CEILING PLAN
 SCALE: 3/32" = 1'-0"



LEGEND

	FLUORESCENT LIGHT FIXTURE		SPRINKLER HEAD
	BATTERY PACK EMERGENCY FIXTURE		THERMOSTAT
	EXIT SIGN		POWER PANEL
	TOILET FLUSH VALVE		DIFFUSER / RECEIVER
	SONNLIGHT FIXTURE		FA BOXES
	FIRE EXTINGUISHER		

LEASE LINE: PER BOMA 265.5-2010

LEASING INQUIRIES
PHONE: 877.206.5656
 EMAIL: LEASING@IRCRETAILCENTERS.COM
IRCRETAILCENTERS.COM