

Shoppes at Grayhawk - Bay 18

144th Street & West Maple Road
Omaha, Nebraska 68116

Existing Construction:

- Area: 2,238 Sq. Ft.
- Elec.: 200 Amp Panel
- Front: Alum. Storefront
- Sides: Gyp. Bd. Demising Wall
- Rear: Gyp. Bd. over Furring over Masonry
- Open 1: Outlets & Tele/Data - Misc. Locations
Track Lighting
Paint
- Open 2: Outlets & Tele/Data - Misc. Locations
2x4 ACT Ceiling
2x4 Fluorescent Lights
Casework w/ Sink
- Toilet(s): ADA
2x4 ACT Ceiling
2x2 Fluorescent Lights
Lavatory
Water Closet
Paint
- Stor.: 2x4 ACT Ceiling
Paint

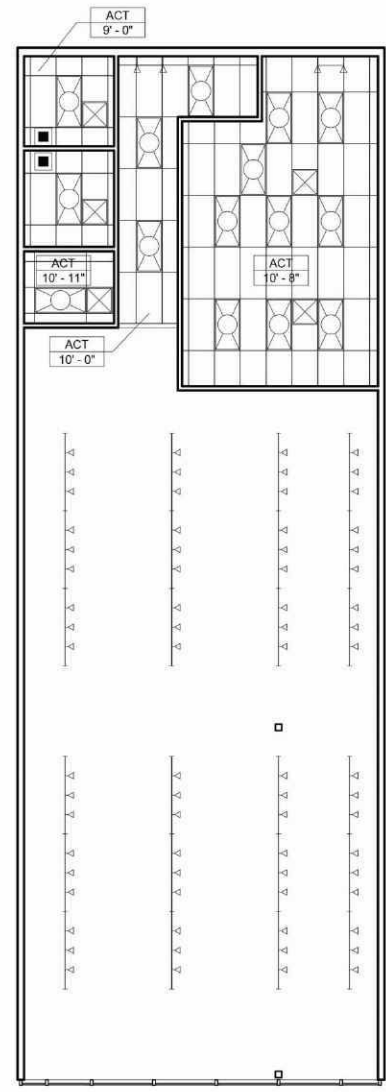
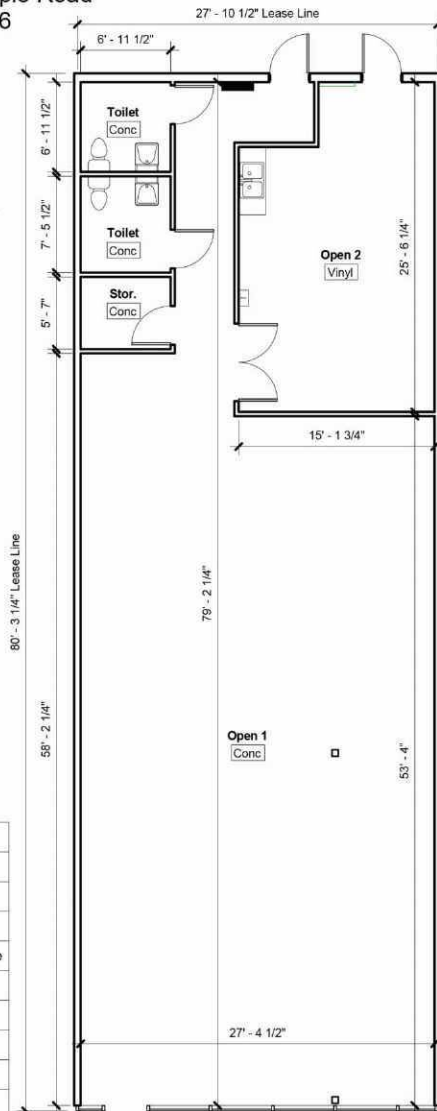

LEGEND	
	2x4 Fluorescent Light Fixture
	2x2 Fluorescent Light Fixture
	Fluorescent Strip Fixture
	Battery Pack Emergency Fixture
	Exit Sign
	Fire Extinguisher
	Diffuser / Register
	Track Lights
	Ceiling Fixture
	F.A. Devices
	Sprinkler Head
	Thermostat
	Electrical Panel

1 Floor Plan
3/32" = 1'-0"

2 Ceiling Plan
3/32" = 1'-0"

slate architecture

3624 Farnam Street
Omaha, Nebraska 68131

Tel | 402.342.5575
www.slatearchitecture.com

Project Number: Project Number
Printed Date: 2/6/2013 3:31:32 PM

LEASING INQUIRIES
PHONE: 877.206.5656
EMAIL: LEASING@IRCRETAILCENTERS.COM
IRCRETAILCENTERS.COM